

**C. Brad Peterson**  
**Environmental Management and Landscape Architecture**

Tel 519 763-5260 Fax 519 763-5261 e-mail edc@sentex.net

Dec.01

Y E A R I N R E V I E W

# newsletter

Dear Client, Colleague, Friend:

Year 2001 has been exciting and rewarding.

CBP has carried out a stimulating array of planning, design and on-site supervision projects. Clients have included private landowners, businesses and provincial agencies, in both urban and rural settings. Size of projects has ranged from small backyards to hundreds of acres.

As always, our focus is environmental - the sustainable and joyful association of natural systems with human activity that create truly integrated ecosystems.

I am entirely grateful toward and appreciative of those I have worked with this past year, and look forward to new collaboration and challenges in 2002. Together we will help create a diverse and healthy world in which to live, learn, enjoy, protect and use sustainably.

Please take a moment to review this sampling of projects from 2001. I'm sure you will agree this is a time to celebrate a great year in review.

Brad Peterson

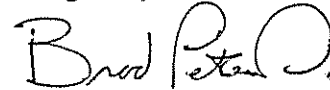

## Cruickston Park Farm - Vision of Landscape Management

Working with Nicholas Hill Heritage Architect Planner of Guelph, six landscape units encompassing the entire property were defined based on existing land use, cultural heritage and bio-physical characteristics.

Each landscape unit was carefully described, and vision statements were provided on how the land could best be managed to:

- ▶ preserve countryside aesthetics,
- ▶ protect and restore the natural environment, and
- ▶ carry out sustainable land-based (farm) production.

The vision report considered many related factors, such as public and private trail systems, converting a historic barn to an interpretive facility, demonstration of organic agriculture.

The visioning exercise culminated in a widely distributed multi-colored flyer called "Cruickston Park a vision for conservation and education".

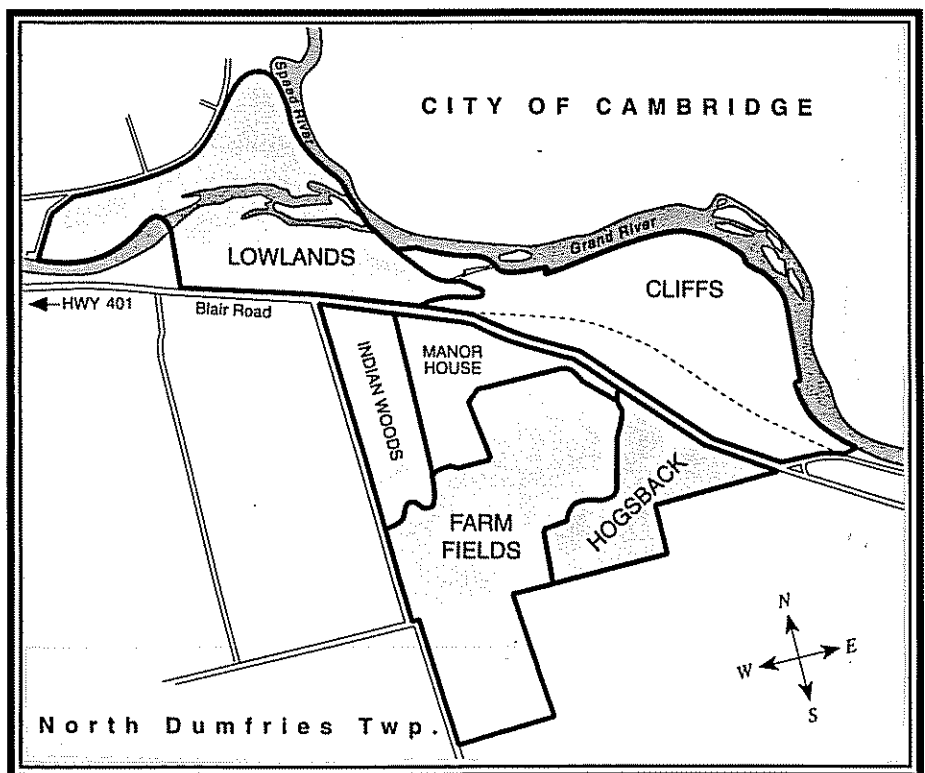

The Six Landscape Units of Cruickston Park Farm



# de Loe residence Landscape Master Plan

The de Loe property in Guelph is a typical subdivision lot - except the rear yard is very steeply sloped upward.

A design solution was found that permitted adults and children to easily negotiate "the hill" to a quiet rear lot line retreat - with a great view to adjacent natural areas.

The Landscape Master Plan also included plantings for the front yard, design of steps and a concrete paver driveway, improved side yard drainage, a food garden and naturalized "lower maintenance" landscape for the rear yard.

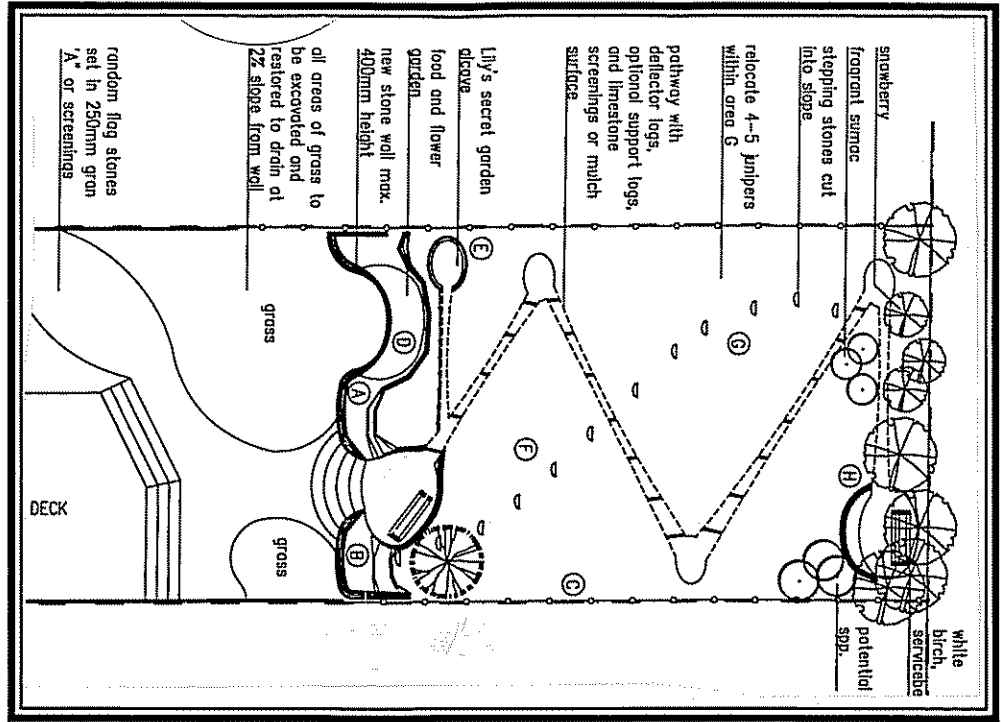

Portion of de Loe Landscape Master Plan

# Wings of Paradise - Butterfly Habitat Master Plan

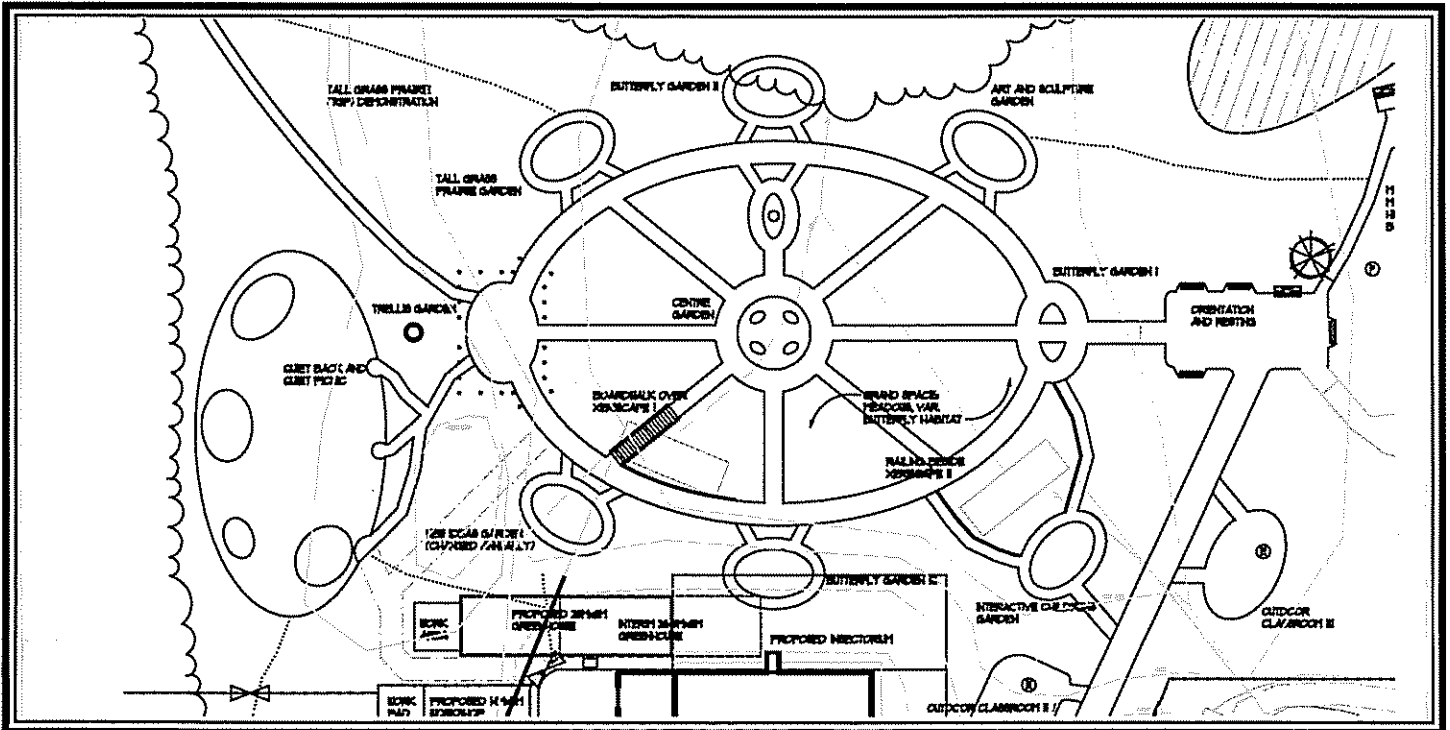

Portion of "Wings" Butterfly Habitat Landscape Concept Plan



Wings of Paradise is an exciting new butterfly naturium located near Cambridge, Ontario.

CBP was retained to design an outdoor butterfly habitat landscape that will feature several unique

backyard habitat "demonstration" gardens set within a nature trail system, hedgerows, tallgrass prairie plantings and various wildflower meadows.

The Master Plan includes Concept, Planting and Servicing plans, with timing and cost schedules.

C. Brad Peterson Environmental Management and Landscape Architecture

59 Essex Street, Guelph, Ontario, N1H. 3K9 Tel 519 763-5260 Fax 519 763-5261 E-mail edc@sentex.net